

REV	DESCRIPTION	DATE	BY
A	NEW DRAWING	02/08/2016	MN

SKT4239

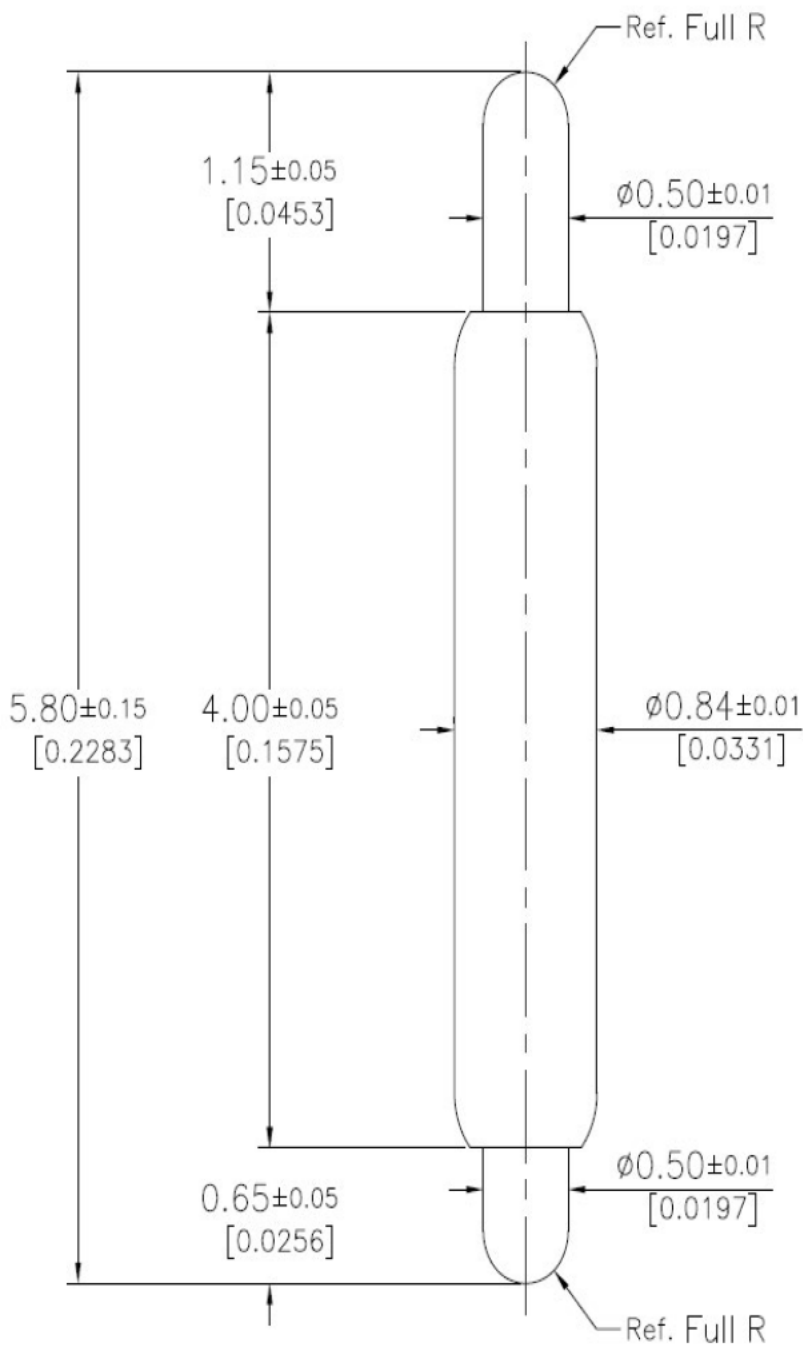

[ Device side ]

Pointing Accuracy: ± 0.05 mm

Spring Force: ± 20%

STATE	TRAVEL	SPRING FORCE
Initial Travel	--	13.5g (0.476oz)
Recommended Travel	0.70mm (0.0276")	31.0g (1.093oz)
Full Travel	1.30mm (0.0512")	45.8g (1.612oz)

PART	MATERIAL	FINISH
Spring	Special SUS Spring 2	Gold Plated
Barrel	Phosphor Bronze	Gold Plated
Plunger [Device Side]	Hardened Beryllium Copper	Gold Plated
Plunger [Board Side]	Hardened Beryllium Copper	Gold Plated

[ Board side ]

ALL DIMENSIONS ARE IN MILLIMETERS UNLESS OTHERWISE SPECIFIED

**EMULATION TECHNOLOGY, INC.**  
 VLSI and SMT ADAPTERS and ACCESSORIES  
 741 FLYNN ROAD  
 CAMARILLO, CA 93012  
 TEL: (805) 383-8480  
 FAX: (805) 383-8484

**ET**

SHEET: 1 OF 1	DATE: 2/8/2016	REVISION: A	<b>ASSEMBLY DRAWING</b>
CHECKED: Janice Gelacio	PREPARED BY: Marco Nunes	ITEM: <b>POGO-PIN-5.80-7</b>	DESCRIPTION: <b>POGO-PIN-5.80-7</b>
<b>DO NOT SCALE DRAWING</b>			