

REV	DESCRIPTION	DATE	BY
A	NEW DRAWING	01/05/10	JAG

SKT3381

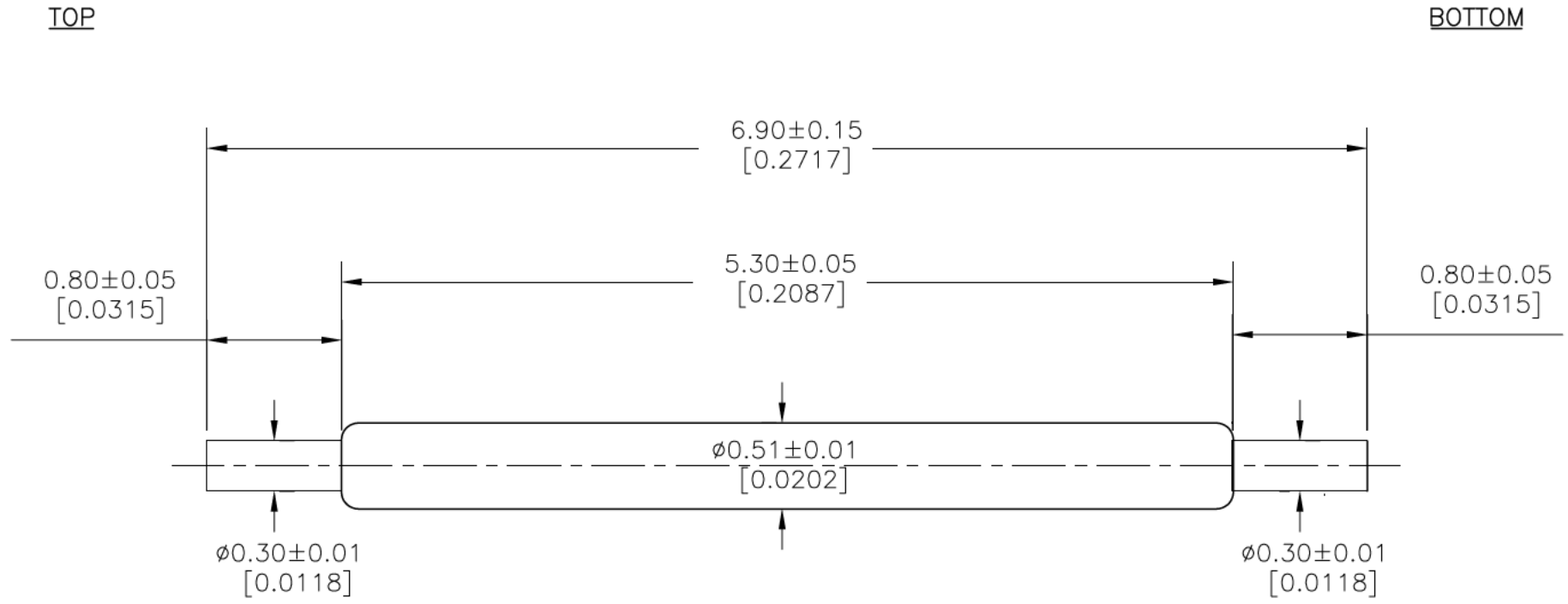

POINTING ACCURACY: $\pm 0.05\text{mm}$

SPRING FORCE: [$\pm 20\%$]

- 6.0g (0.212oz) AT INITIAL TRAVEL
- 24.6g (0.868oz) AT 1.10mm (0.0433) RECOMMENDED TRAVEL
- 33.1g (1.168oz) AT 1.60mm (0.0630) FULL TRAVEL

CRES
 AVG = 300mOhm
 STDDEV = 50mOhm

MATERIAL & FINISH

- PLUNGER (x2) HARDENED BERYLLIUM COPPER / GOLD PLATED
- BARREL PHOSPHOR BRONZE / GOLD PLATED
- SPRING MUSIC WIRE / GOLD PLATED

ALL DIMENSIONS ARE IN MILLIMETERS UNLESS OTHERWISE SPECIFIED

EMULATION TECHNOLOGY, INC.
 — VLSI and SMT ADAPTERS and ACCESSORIES —
 759 FLYNN ROAD
 CAMARILLO, CA 93012
 TEL: (805) 383-8480
 FAX: (805) 383-8484

SHEET: 1 OF 1	DATE: 01/05/10	REVISION: A	ASSEMBLY DRAWING
CHECKED:	DRAWN: J. GELACIO	ITEM: POGO-PIN-6.90-1	DESCRIPTION: POGO-PIN-6.90-1
DO NOT SCALE DRAWING			